

# PUFFClicker™

Smart pMD Inhaler Tracker



**Compatible with pMD Inhalers:**  
Clenil Modulite, Salbutamol (Ventolin Evohaler), Salbutamol (Ivax Salamol), Flixotide Evohaler, Seretide Evohaler, Fostair, Atimos Modulite & Trimbow.

**Activ8rlives' PUFFClicker can connect to:**



Activ8rlives<sup>4</sup> Health+Wellness App  
(Free)



Asthma<sup>+</sup>me App  
(Subscription)



Active<sup>+</sup>me REMOTE Recovery App  
(Subscription)



[www.activ8rlives.com](http://www.activ8rlives.com)



PUFFClicker connects via Bluetooth 4.0 and uploads data to Asthma<sup>+</sup>me, Active<sup>+</sup>me REMOTE or Activ8rlives<sup>4</sup> Health+Wellness App. Works with: Bluetooth Smart Ready device (typically Bluetooth 4.0+), iOS 12+ or Android 10+.



We are a healthcare company. Our mission is to empower you to take care of your health and that of your family by self-care through self-monitoring.

From tracking levels of physical activity, weight, food intake, cardiovascular and lung function, to a new generation of at-home testing for long-term lung disease, we provide the devices and web-based tools to help you be active, eat well and stay healthy. Learn more at [www.activ8rlives.com](http://www.activ8rlives.com)



# PUFFClicker™

Smart pMD Inhaler Tracker

## Your Activ8rlives PUFFClicker

Please read this manual carefully before you use your new device so that you do not injure yourself or others or cause damage to your new device through improper use.

## Intended Use

The **Activ8rlives PUFFClicker** is a Class I smart inhaler dose counter used together with commonly prescribed pressurised metered dose inhalers (pMDI) for asthmatic children and young people (CYP 6-12-years under adult supervision) and adults with asthma, COPD and other respiratory conditions connected to either the **Asthma<sup>+</sup>me**, **Active<sup>+</sup>me REMOTE** or **Activ8rlives<sup>4</sup> Health+Wellness Apps**, which allow the lay user to count their doses of inhaler, record their steps, add reminders to take medication and indicates that the inhaler has been shaken adequately to disperse the medication. The **PUFFClicker** is a Class I medical device with both CE- and UKCA-mark.

 **If in any doubt about your health, please consult your medical team first and follow their advice closely.**

## Your Activ8rlives PUFFClicker

The **Activ8rlives PUFFClicker** is made up of the **Module**, **Cap**, **Clip**, **USB Charging Cable** and prescribed Inhaler (not provided).

The **Activ8rlives PUFFClicker module** has a rechargeable battery, which cannot be removed. There are no user-serviceable parts and opening the **Module** case will void your warranty.

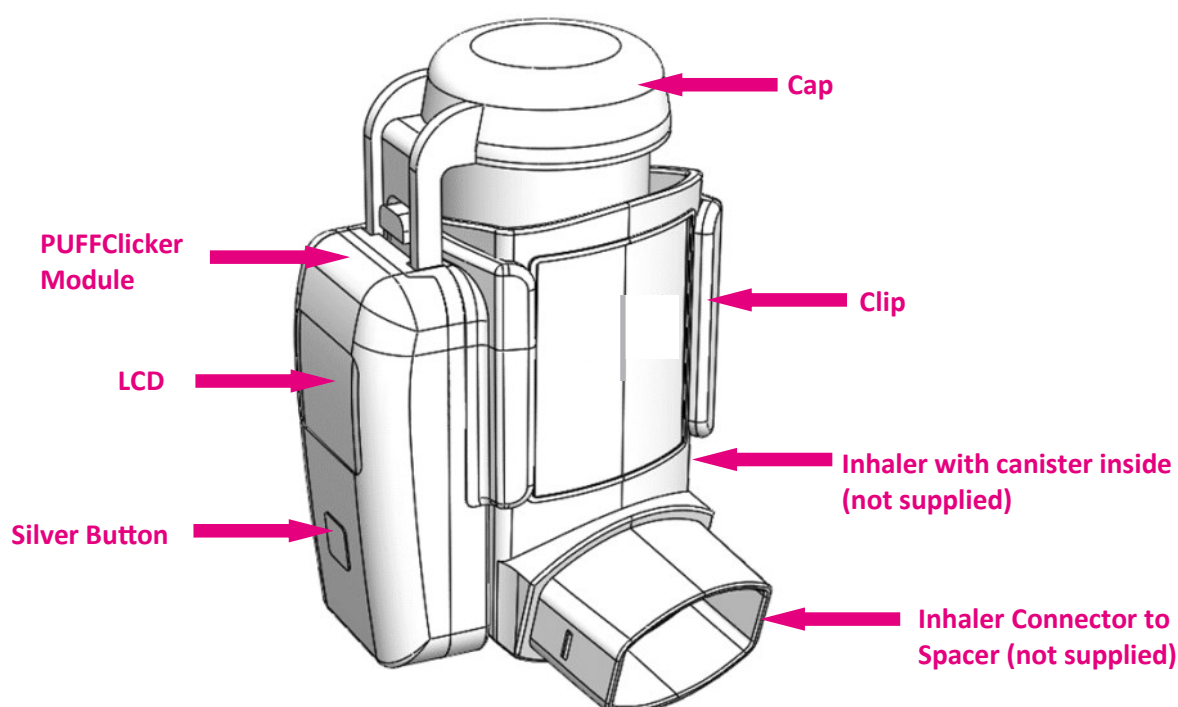

## Health and Safety Notices

 **WARNINGS:** The **Activ8rlives PUFFClicker** contains small internal components and magnets that may cause a choking hazard.

 **WARNING:** Avoid using the **Activ8rlives PUFFClicker** in strong electrostatic and electromagnetic fields as these may cause the **Activ8rlives PUFFClicker** to reset. The **Activ8rlives PUFFClicker** will need to be reconnected to the **Asthma+me, Active+me REMOTE** or **Activ8rlives<sup>4</sup> Health+Wellness Apps** if this occurs.

**MEDICAL ALERT:** Asthma, COPD or other respiratory conditions can be a life-threatening condition. Always take the medication as prescribed. If you experience any respiratory-related symptoms of shortness of breath that does not get better after using your Reliever inhaler; trouble walking and talking because of shortness of breathe; blue lips or fingernails; severe wheezing; or a peak flow reading of less than 50% of your personal best, refer to your **Care Plan or PAAP** and follow the instructions carefully. If you continue to have symptoms, consult your medical team. Do not rely on the **Activ8rlives PUFFClicker** to diagnose or manage your respiratory condition.

This device is not a toy. Only recommended for children with asthma 5-18 years, with 5-12 years under adult supervision, and adults with COPD or other respiratory conditions.

Can be wiped clean with an antiseptic wipe and dried with a soft microfiber cloth. Do not use harsh cleaning products as these will cause damage to your **Activ8rlives PUFFClicker**. Do not allow sharp objects to scratch the device as this may damage it and make it more difficult to clean.

The **Activ8rlives PUFFClicker Module** is not waterproof. Do not submerge it in water or put into a washing machine or dryer, as this will irreparably damage it.

Do not allow your **Activ8rlives PUFFClicker** to be subjected to forces, shocks, dust, temperature changes or humidity over the range specified at the back of this User Manual. Harsh physical treatment may stop your **Activ8rlives PUFFClicker** from working properly. Don't expose your **Activ8rlives PUFFClicker** to direct sunlight for long periods of time.

Do not remove the back cover of the **Module** and tamper with the internal components. If you do, you will damage the device. The **Activ8rlives PUFFClicker** also contains small internal components, which present a serious choking hazard for small children. Only use under adult supervision.

 Do not rely solely on the **Reminder** capabilities of the **Activ8rlives PUFFClicker, Asthma+me, Active+me REMOTE** and **Activ8rlives<sup>4</sup> Health+Wellness Apps**, to take your prescribed medication as directed by your Medical Team.

The **Activ8rlives PUFFClicker Module** contains a rechargeable lithium battery. It takes about 120-minutes to charge and with typical use, will last 10-14-days before recharging is required. Only use the **Magnetic USB Charging Cable** supplied. Avoid rapid chargers over 1Amp as these decrease the lifetime of your rechargeable battery. The typical lifetime of this products rechargeable battery is 200-300 charges. If you are planning to store the device for a long period of time, charge it first before storage. When disposing of the **Module**, ensure that it is collected separately for special treatment as it contains a lithium battery that should not be disposed of as normal household waste.

 The technical specifications for this product and the contents of this User Manual are subject to change without notice by the manufacturer.

 If you experience any serious incident that occurs in relation to this device, please report this to Aseptika Limited (**Activ8rlives**) and the competent authority of the Country in which you are based.

**Customer Support 7-days-a-week, between 09:00—18:00 on UK +44 (0)1480 352 821 or support@aseptika.com**



## How Does the Activ8lives PUFFClicker Work?

The **Activ8lives PUFFClicker** has a built-in sensor and counter that enables it to count the number of puffs you take of your Asthma pMD inhaler when you press down on the **Cap** at the top of the device.

It also has a 3-axis accelerometer chip and a microprocessor, which detects how you move (accelerate) in three dimensions and this allows it to count how many steps you take each day if you carry it with you (ideally carry your blue Reliever with you everywhere). It also is used to calculate if you have shaken your inhaler, before you use it, to maximise the inhaler drug delivered to your lungs.

## Which Inhalers are Compatible with the PUFFClicker?

The **Activ8lives PUFFClicker** is a smart dose inhaler counter to be used with pressurised metered-dose inhalers (pMDI) and is available in 5 different sizes so that they can be used with these different inhalers listed in the table below.

The **Activ8lives PUFFClicker** is clipped over your inhaler and is transparent in colour so you can easily see which inhaler you are about to use.



The PUFFClicker supports the following pressurised metered-dose inhalers pMDI's: Clenil® Modulite®Chiesi Limited, Flixotide Evohaler®GlaxoSmithKline / Seretide Evohaler®GlaxoSmithKline, Fostair®Chiesi, Ventolin® Evohaler GlaxoSmithKline and Ivax Salamol®Teva Pharmaceuticals. Not included in this figure are: Atimos Modulite®Chiesi Limited and Trimbow®Chiesi Limited.

## Which Activ8rlives App Will Suit the Needs of your Asthma or Lung Condition?

Feature	Asthma <sup>+</sup> me App 	Active <sup>+</sup> me REMOTE App 	Activ8rlives <sup>4</sup> Health+Wellness App 
Cost	Monthly subscription	Monthly subscription	Free of charge
Parent / Child Registrations	✓		
Count your Inhaler usage	✓	✓	✓
List your Triggers	✓	✓	
Add your Medication	✓	✓	✓
Reminder to do Daily monitoring tasks	✓	✓	
Set-up Care Plan or PAAP and Print	✓	✓	
Daily Symptom Surveys	✓	✓	
Weekly Symptom Surveys	✓		
Asthma Lessons	✓		
Emergency Contact Details for Parent/Carer	✓	✓	
Set-up Rewards to increase adherence to Care Plan	✓	✓	
Connect to your Hospital account (where supported)	✓	✓	
Children can customise the look of their account	✓		
Generate Reports of Asthma data and print	✓	✓	
Adding Data Manually	✓	✓	✓
Weather and Pollution details in your location	✓		
Connect other Activ8rlives devices	✓	✓	✓
Asthma specific	✓		



## Why Register as a Parent/Carer?

Use the option in the **Asthma<sup>+</sup>me App** if your child is 6-12-years or not yet ready to manage their own asthma. Instructions are provided within the **Asthma<sup>+</sup>me App** for a **Parent/Carer** (we call them the **Carer**) that manages their child(ren)'s asthma and require access to their child's data. Your child can have their own smart devices or you can share your device with them. Please follow the instructions provided on screen if you are **Registering** an account as a **Parent/Carer** for your child.

## Register as Parent (Carer)

Once you have installed the **Asthma<sup>+</sup>me App**, open the App making sure your Smartphone or Tablet is connected to the internet with **Bluetooth switched on**. **Registered** and **Login**. Follow the instructions provided on the **Asthma<sup>+</sup>me App** screen.

**Note:** Your contact details, including your telephone number will be used in the **Emergency Contact Details** section of the child's **Care and Action Plan** or Personalised Asthma Action Plan (**PAA P**).

## About Your Child's Asthma

Your child's peak flow will be automatically calculated based on their parameters for age, gender and height provided upon **Registration**. You can input their own targets if they have been given different values by their doctor.

Tick all of the triggers that apply to your child (**Caree**) as these settings are used to populate your child's **Care Plan** or **PAAP** and to make the **Asthma<sup>+</sup>me** experience relevant to them.

Follow the instructions provided on the **Asthma<sup>+</sup>me App** screen.

## Registration for 13 Years—Adults

Anyone over the age of 13-years that has asthma, COPD or other respiratory condition that does not want to share their data with a Parent/Carer may set-up their own account for themselves.

Follow the instructions provided on the **Asthma<sup>+</sup>me App** screen if you're **Registering** an account **Just for myself**.

**Note:** Details for the **Emergency Contact Details** that are inserted into your **Care Plan** or **PAAP** will need to be that of a **Parent/Carer** so that in an emergency someone else other than you can be contacted.



## Let's get started with the Set-up and Connect to the Asthma<sup>+</sup>me App

The **Activ8rlives PUFFClicker** is programmed by and uploads information directly to and from your **Activ8rlives** account each time your Smartphone or Tablet (not included) is connected to it wirelessly by Bluetooth 4.0.

This guide will show you how to:



Install the **Asthma<sup>+</sup>me** (or **Active<sup>+</sup>me REMOTE**) **Apps** to your iOS or Android Smartphone or Tablet.

Register as a Parent / Carer and your Child or just for Yourself.

Settings and features to personalise your **Asthma<sup>+</sup>me** experience.

If you follow these directions sequentially, it will take you about 10-15 minutes to learn how to count your inhaler doses, activity and connect to the **Asthma<sup>+</sup>me App**.

**Skip to Page 10-11 if you wish to use the free Activ8rlives<sup>4</sup> Health+Wellness App**

### Intended Use for the Asthma<sup>+</sup>me App:

The **Asthma<sup>+</sup>me App** is a Class IIa under MDR 2017/745 medical device mobile application and cloud services intended for use in the home to assist children and young people (CYP 6-18-years) to receive and review information from connected medical and non-medical devices, track medication use and record other asthma events, such as asthma attacks, for effective health self-management. The CYP user can also share the data via sharing functions.

### Health and Safety Notices for the Asthma<sup>+</sup>me App:

- ⚠ **Asthma<sup>+</sup>me App** is not intended to monitor vital physiological parameters where variation could result in immediate danger.  
Asthma can be a life-threatening condition. Always take the medication as prescribed. If you experience any
- ⚠ asthma-related symptoms of shortness of breath that does not get better after using your Reliever inhaler; trouble walking and talking because of shortness of breath; blue lips or fingernails; severe wheezing; or a peak flow reading of less than 50% of your personal best, refer to your **Care Plan** or PAAP and follow the instructions carefully. If you continue to have symptoms, consult your medical team.
- ⚠ Do not rely on the **Asthma<sup>+</sup>me App** to diagnose or treat your Asthma.  
Only recommended for children 6-18 years and under adult supervision for children 6-12 year.
- ⚠ Do not rely solely on the **Reminder** capabilities of the **Asthma<sup>+</sup>me App** to take your prescribed medication as directed by your medical team.

If you experience any serious incident that occurs in relation to the **Asthma<sup>+</sup>me**, please report this to Aseptika Limited (**Activ8rlives**) and the competent authority of the Country in which you are based. Contact details are on the back of this User Manual.





## Installing the Asthma<sup>+</sup>me App on Your Smartphone or Tablet (Bluetooth 4.0 Enabled Devices are required to use the PUFFClicker and Asthma<sup>+</sup>me App require a Subscription).

Download the Asthma<sup>+</sup>me App from the App Store appropriate to your device. Search for Asthma<sup>+</sup>me in the search bar of your App Store or scan the QR code below and it will take you to the appropriate App Store for your device.



Asthma+me



Apple devices running iOS 12+ that are Bluetooth Smart Ready (typically Bluetooth 4.0+).



Android devices running Android 10+ that are Bluetooth Smart Ready (typically Bluetooth 4.0+).

**IMPORTANT NOTE:** Please adjust the screen lock function on your Smartphone or Tablet to be longer than 2 minutes to allow the Activ8rlives PUFFClicker time to sync with your device.

Short times of less than 2 minutes cause frequent loss of connectivity.



**Help Videos** in App, follow this ?



Website [www.Activ8rlives.com](http://www.Activ8rlives.com)

YouTube <http://bit.ly/Activ8rlives>

### Still Need Help

We are here to help you 7-days-a-week, so please call us to help you set-up your device on UK +44 (0)1480 352821.



## Let's get started with the Set-up and Connect to the Activ8lives<sup>4</sup> Health+Wellness App (Free App no subscription required)

The **Activ8lives PUFFlicker** is programmed by and uploads information directly to and from your **Activ8lives** account via the **Activ8lives<sup>4</sup> Health+Wellness App** each time your Smartphone or Tablet (not included) is connected to it wirelessly by Bluetooth 4.0.

This guide will show you how to:



Install the **Activ8lives<sup>4</sup> Health+Wellness App** to your iOS or Android Smartphone or Tablet.

Register for an **Activ8lives** Account.

If you follow these directions sequentially, it will take you about 10-15 minutes to learn how to count your inhaler doses, activity and connect to the **Activ8lives<sup>4</sup> Health+Wellness App**.



**Skip to Page 8-9 if you wish to use the subscription Asthma<sup>+</sup>me App**

### Intended Use for **Activ8lives<sup>4</sup> Health+Wellness App**:

**Activ8lives<sup>4</sup> Health+Wellness App** is a Class I medical device mobile application intended for use in the home to assist people to receive and review information from connected medical and non-medical devices, track medication use, for effective health self-management. The user can also share their data via sharing functions. The **Activ8lives<sup>4</sup> Health+Wellness App** is intended for use by 5-80+ years, with adult supervision for 6-12 years.

### Health and Safety Notices:

**Activ8lives<sup>4</sup> Health+Wellness App** is not intended to monitor vital physiological parameters where variation could result in immediate danger.

-  Long-term health conditions (LTHC) can be life-threatening. Always take medication as prescribed. If you experience any LTHC-related symptoms, refer to your **Care Plan** and follow the instructions carefully. If you continue to have symptoms, consult your medical team.
-  Do not rely on the **Activ8lives<sup>4</sup> Health+Wellness App** to diagnose or treat any long-term health condition. Only recommended for children 5-years-old and only under adult supervision for children 5-12-years-old.
-  Do not rely solely on the Reminder capabilities of the **Activ8lives<sup>4</sup> Health+Wellness App** to take your prescribed medication as directed by your medical team.



## Installing the Activ8lives<sup>4</sup> Health+Wellness App on Your Smartphone or Tablet (Bluetooth 4.0 Enabled Devices are required to use the **Activ8lives PUFFClicker**)

Download the **Activ8lives<sup>4</sup> Health+Wellness App** from the App Store appropriate to your device. Search for **Activ8lives** in the search bar of your App Store or scan the QR code below and it will take you to the appropriate App Store for your device.



Activ8lives



Apple devices running iOS 12+ that are Bluetooth Smart Ready (typically Bluetooth 4.0+).



Android devices running Android 10+ that are Bluetooth Smart Ready (typically Bluetooth 4.0+).

**IMPORTANT NOTE:** Please adjust the screen lock function on your Smartphone or Tablet to be longer than 2 minutes to allow the **Activ8lives PUFFClicker** time to sync with your device.

**Short times of less than 2 minutes cause frequent loss of connectivity.**



**Help Videos** in App, follow this ?



Website [www.Activ8lives.com](http://www.Activ8lives.com)

YouTube <http://bit.ly/Activ8lives>



### Still Need Help

We are here to help you 7-days-a-week, so please call us to help you set-up your device on UK +44 (0)1480 352821.

Already have an account setup? Skip straight to step 4

### 1. Download App and register an account

Search: **activ8rlives**

-  **Activ8rlives<sup>4</sup> Health+Wellness** (Free) 
-  **Asthma<sup>+</sup>me** (Subscription) 
-  **Active<sup>+</sup>me REMOTE** (Subscription) 



**Start** →

Scan QR to download

### 2. Turn on Bluetooth

Wi-Fi

### 5. Click the clip on inhaler

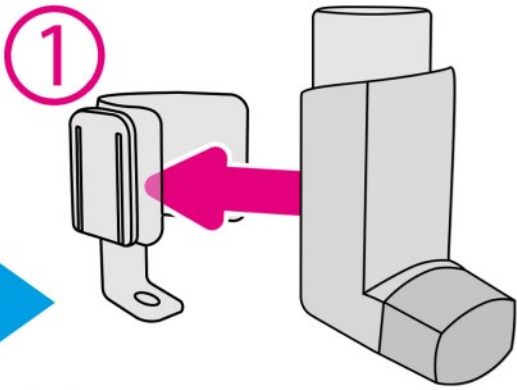

### ② Click the module on clip

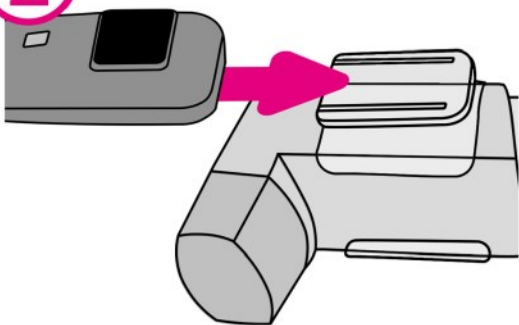

### 6. Click the cap on

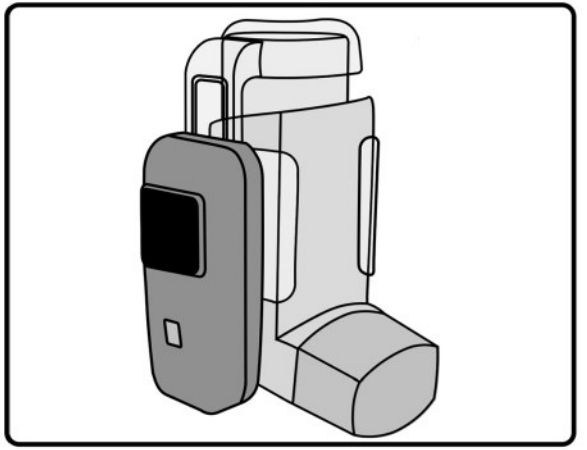

both &

### 3. Register Account



Follow registration process in App.

### 4. Check you have correct clip for your inhaler

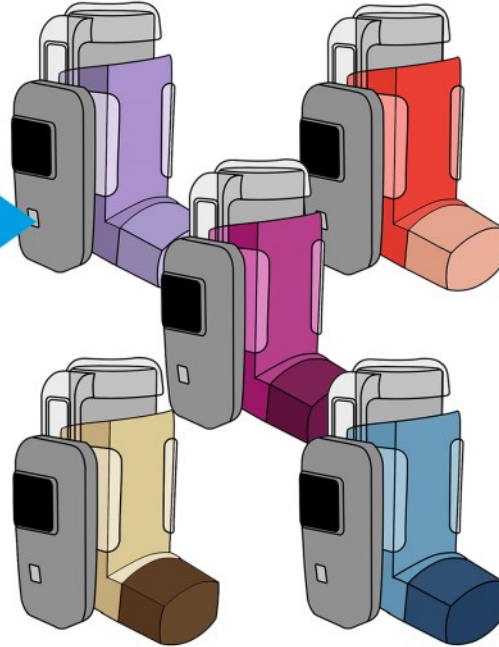

### 7. Charge the module

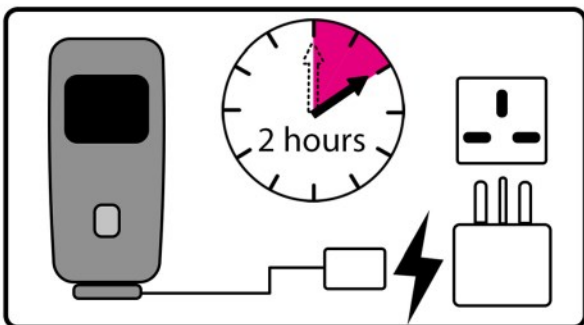
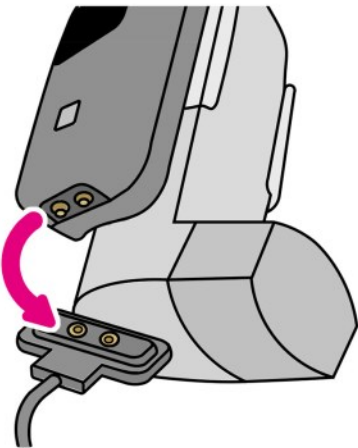

### 8. Setup your inhaler medication in App

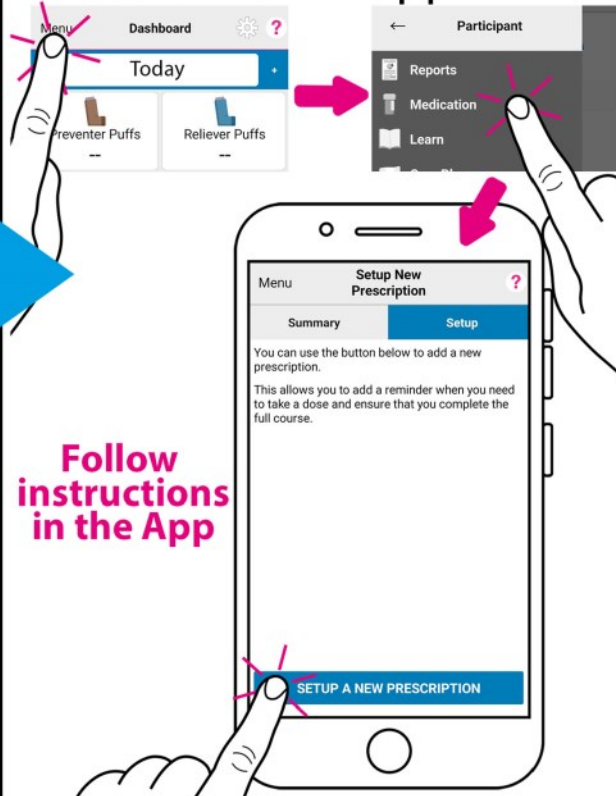

Follow instructions in the App

### 9. Put PUFFClicker into pair mode

① **battery screen**

**HOLD**

②

**QUICK DOUBLE TAP**

③ **pair mode screen**

### 10. Connect PUFFClicker to your medication in App

**Follow instructions in the App**

### 13. Wait 30 seconds before shaking to take another dose

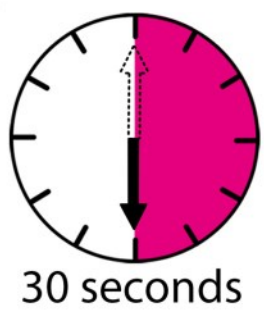

### 14. View and upload your doses on the dashboard

**Send Data now**  
Up to date

## 11. Shake inhaler until it buzzes

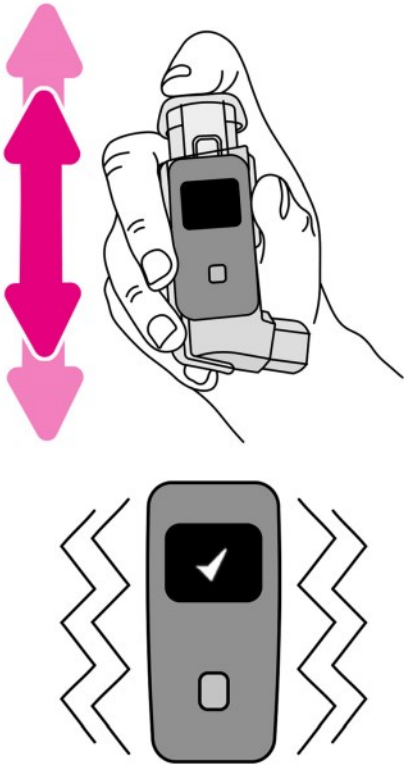

## 12. Take a puff of the inhaler

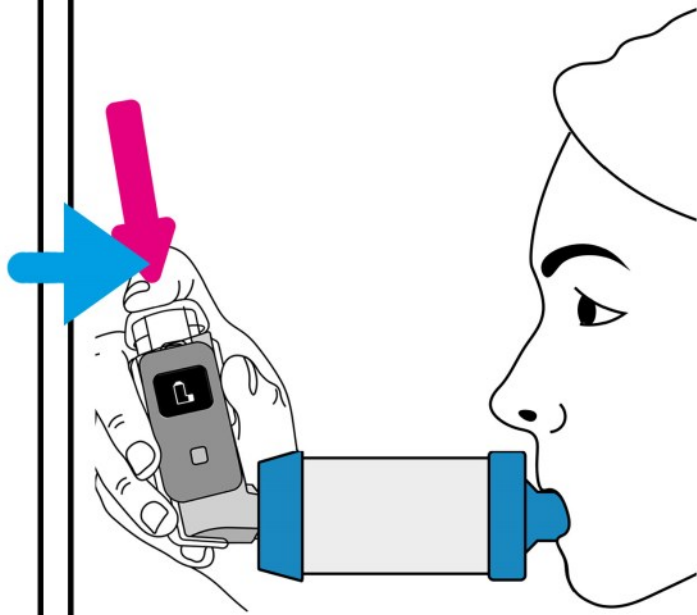

## 15. Technical help

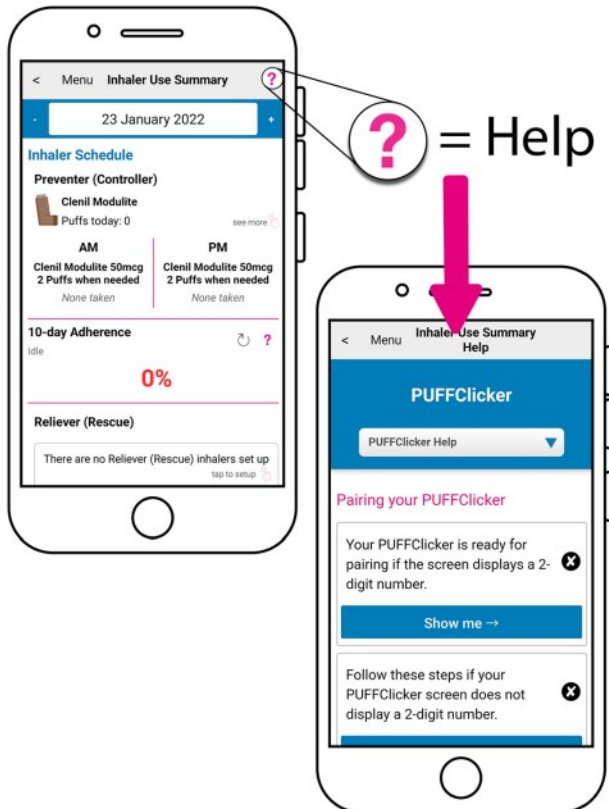

## 16. Keep this booklet safe



### **WARNING**

**Do not rely solely on the Reminder capabilities of the Activ8rlives PUFFClicker to take your prescribed medication as directed by your Medical Team.**

**End**

**Activ8rlives Technical Support**

Phone: 01480 352 821 (UK)

Email: [support@aseptika.com](mailto:support@aseptika.com)

ASL MAN/IFU25 TF-003 PUFFClicker Quick Guide (V1.0)



Access via Menu, select Care Plan or PAAP

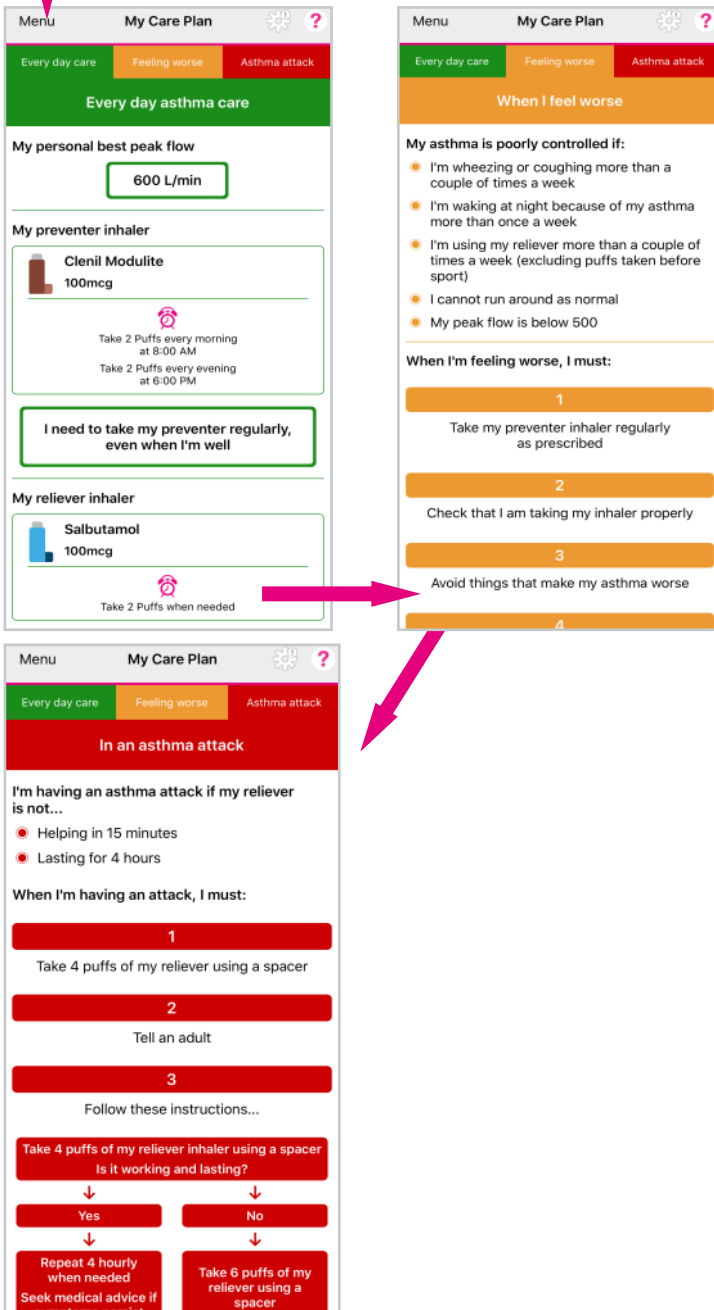

## Care and Action Plans or Personalised Asthma Action Plan (PAAP)

### Everyday Asthma Care

The first part of your **Care Plan** or **PAAP** is what you need to do everyday to stay well - **Everyday Asthma Care**. From this you and anyone who provides medical care for you will know your personal best peak flow, what is the name and strength of your inhalers, how many puffs of preventer you need to take and when to take your reliever based on your **PAAP**. It will also inform you and anyone who provides medical care for you of what other medication you are taking. It will also list your asthma triggers and your next Asthma Review.

### When I Feel Worse

The second part of your **PAAP** will let you and anyone who provides medical care for you recognise signs that you're **feeling worse** and steps you can take straight away to get your asthma back under control and help you feel better.

You should follow the instructions carefully to get your Asthma back under control.

### In an Asthma Attack

The third part of your **PAAP** will let you and anyone who provides medical care for you know what to do in case of an **Asthma Attack**. This section contains the contact details of your **Emergency Contact** (usually a parent/carer/partner), signs showing you're **In an asthma attack** and what emergency actions to take to help you.

You should show this section to an appropriate adult if you think that you are having an asthma attack (such as teacher, scout leader, friend's

The Care & Action Plan or PAAP can be downloaded as a PDF file that you can send via Email and print out copies.





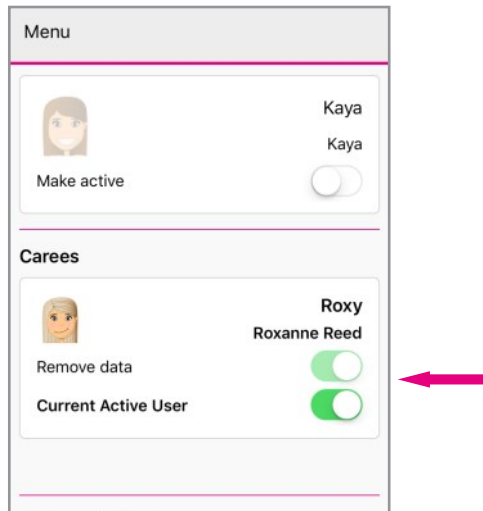

## Rewards

The **Asthma<sup>+</sup>me App** has been designed to incorporate **Rewards** for your Child (Caree), which helps to encourage them to adhere to taking their medication as prescribed and to engage in learning more about their Asthma.

Involve your child in setting an achievable target to earn their **Rewards**.

From the **Menu** select **Rewards Management** and click on the **Setup** tab. Follow the instructions on the **Asthma<sup>+</sup>me App**, by completing the Name of the Reward, Image, Points Target and tick the behaviours that will incentivise them to complete the Daily and Weekly tasks.

You can use the Calculator provided in the **Asthma<sup>+</sup>me App** to work out how long it will take them to earn the **Reward** based on the behaviours you wish to encourage.

Only Parents/Carers can set-up **Rewards**, so make sure the Carees account is active.

Children can view their progress by accessing the **Rewards** page from the **Menu**.

Make this fun for them and reward them for taking care of their Asthma and learning more about how to keep well!

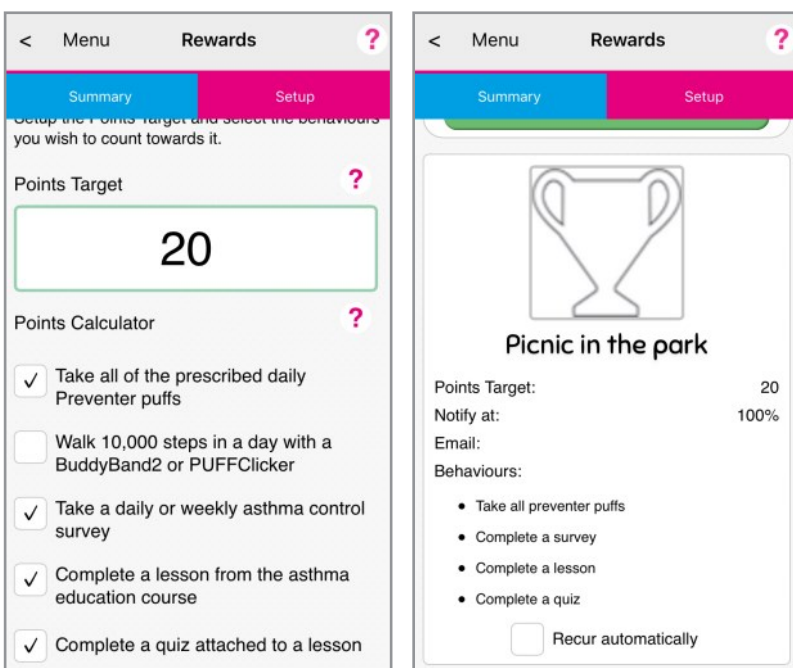
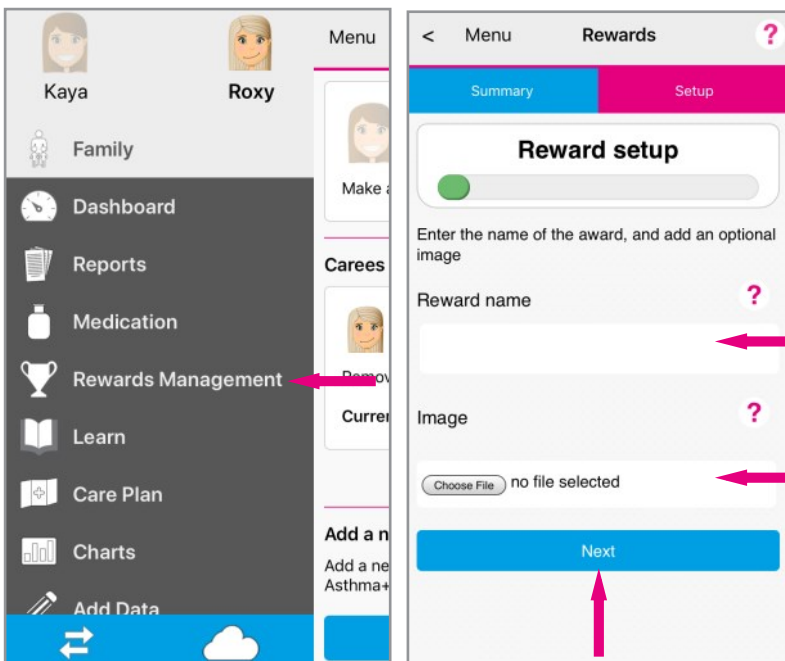



< Menu Add a PUFFClicker

---

**Choose a medication batch**

By assigning this PUFFClicker to a medication batch, you will be able to track how many doses you have left and be alerted when your medication runs low.

(Preventer) Home

---

**Track your steps**

You can use your PUFFClicker to track how many steps you take. Turns this on if you are going to be carrying your PUFFClicker around with you.

Enable step counting

Next

## Enabling Step Counting on your PUFFClicker

If you would like to enable **Step Counting** on your [Activ8lives PUFFClicker](#), navigate to the **Menu**, select **Devices** and scroll to the bottom to **Add a PUFFClicker**. Toggle on the **Enable step counting** and click **Next**.



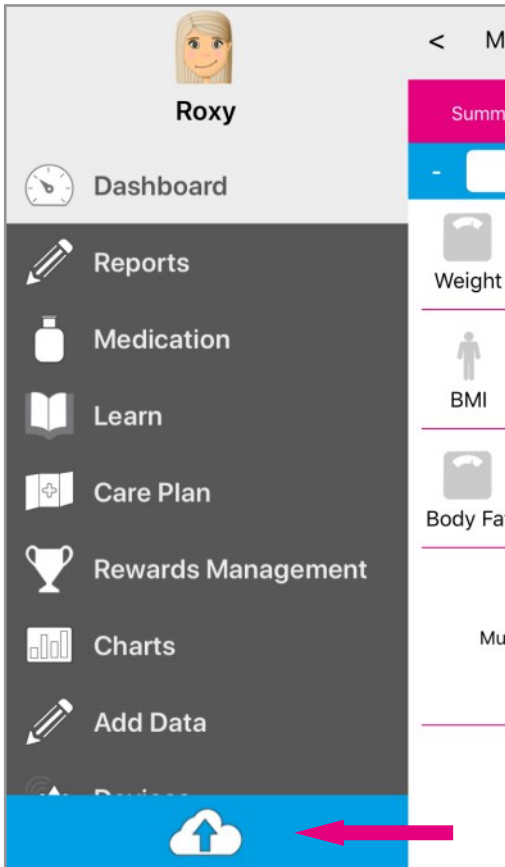

## Sending Your Data to Cloud

If your Smartphone or Tablet is connected to the internet by WiFi, your data will upload to your online [Activ8lives](#) account automatically.

If there is an arrow in the **Cloud** it indicates that you have data to upload to the **Cloud** Server. Touch the **Cloud** icon and it will automatically detect and synchronise if you are on WiFi.

Touch the **Synchronise** bar to upload via Cellular network to upload the data.

By touching the **Download** bar your data will download from the **Cloud** for you to view on the App.

If there are no networks available the data will be uploaded at a later time by either WiFi or Cellular when you are within range. The data is not lost and you do not have to take the reading again.

When the data is stored in the [Activ8lives](#) secure **Cloud**, this means that you can view your data (from today, yesterday, a week, a month or years ago) at any time via the Smartphone App or [Activ8lives](#) website. [www.activ8lives.com](http://www.activ8lives.com)

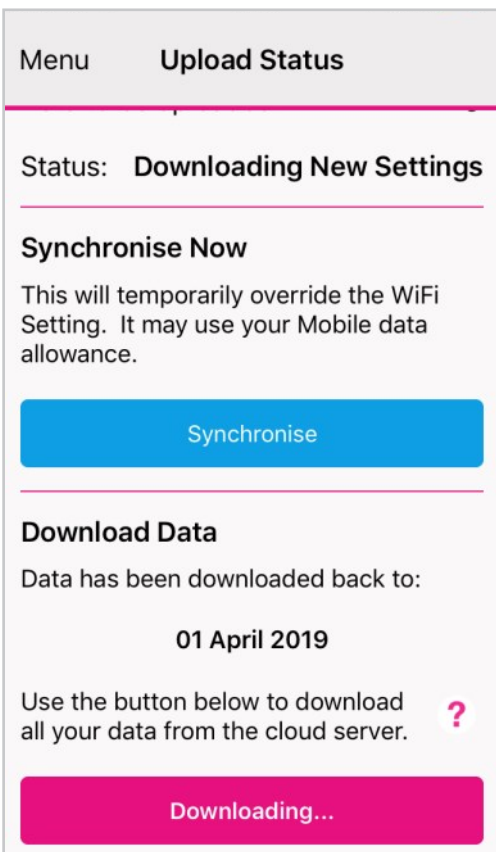

## Data Security

The storage of your data is hosted on our private **Cloud** Server operated by AWS (London, UK). No data ever leaves the UK and we work to the NHS Data Security and Protection Toolkit and Cyber Essentials Plus standards.





## Trouble Shooting

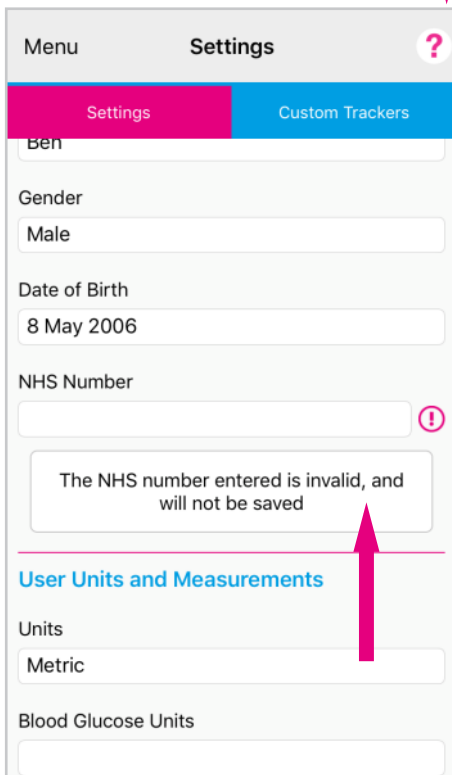

### Help is Always Available

Help can be found on most pages of the **Asthma<sup>+</sup>me**, **Active<sup>+</sup>me REMOTE Apps** or **Activ8rlives<sup>4</sup> Health+Wellness Apps** in the top right-hand corner.

Touch the **?** to expand the page and scroll down through the **Help** information, including viewing the **Help Videos** and **PDF Manual**. Touch **!** to reveal helpful hints.

### Will Not Connect?

Requires a Bluetooth Smart Ready device (typically Bluetooth 4.0+), iOS 12+ and Android 10+.

If the **Activ8rlives PUFFClicker** will not connect to Bluetooth, first check that **Bluetooth is switched on** your Smartphone or Tablet and then touch the **Silver Button** on the **Activ8rlives PUFFClicker** to wake it up (**Page 12-15** provides help if your **Activ8rlives PUFFClicker** needs to be put back into Pairing Mode).

### App Crashes?

Close other Apps open on your Smartphone or Tablet, as these may be using too much memory to allow the **Asthma<sup>+</sup>me**, **Active<sup>+</sup>me REMOTE** or **Activ8rlives<sup>4</sup> Health+Wellness Apps** to function. Rebooting your Smartphone or Tablet often helps.

### Not Recording?

There could be 3 reasons for the **Activ8rlives PUFFClicker** not counting inhaler use:

- It may still be in **Pairing Mode** so you need to follow instruction on **Pages 12-15**.
- It may have lost Bluetooth connection and you will need to put it back into **Pairing Mode** and then reconnect to your Smartphone or Tablet on **Page 12-15**.
- Thirdly, your **Activ8rlives PUFFClicker** may be stuck on **00:00** and it may need a **Reboot**. See **Page 21** for rebooting procedures.



**Help Videos** in **App**, follow this **?**

Website [www.Activ8rlives.com](http://www.Activ8rlives.com)

YouTube <http://bit.ly/Activ8rlives>

### Still Need Help

We are here to help you 7-days-a-week, so please call us to help you set-up your device on UK +44 (0)1480 352821.



Place on  
Charging Cable  
Double Tap Silver  
Button & Module  
vibrates

## Reboots

Just as with many electronic devices, they sometimes need a reboot to take them back to the original or default settings and the [Activ8lives PUFFClicker](#) is no exception to this.

There are two methods for Rebooting if your module becomes stuck:

### Rebooting Without Data Loss

Your [Activ8lives PUFFClicker](#) can simply be rebooted by placing it on the **USB Charging Cable** as if you were charging it. Tap the **Silver Button** twice in quick succession.

The [Activ8lives PUFFClicker](#) will vibrate and your data should still be on your [Activ8lives PUFFClicker](#) after the reboot.

### Rebooting With Data Loss

The first method of rebooting above is very effective but it may need the second method of reboot.

**Note:** You may lose data unless you have already uploaded the data to your **Account**.

Rotate the [Activ8lives PUFFClicker](#) by 180° or half a circle. The metal magnetic pins on the bottom of the [Activ8lives PUFFClicker](#) module will try to push it away as you try to push together the metal magnetic pins on the **USB Charging Cable**.

**TIP:** Hold the **USB Charging Cable** in the same place with one hand. With the other hand take the [Activ8lives PUFFClicker](#) off the **Charging Cable** and rotate it so that the charging pins are pushing against the charging pins on the [Activ8lives PUFFClicker](#). You will have to juggle the module and **Charging Cable** to push the pins together until you see a **Green LCD light** come on within the [Activ8lives PUFFClicker](#) module. This will indicate that it has been rebooted.

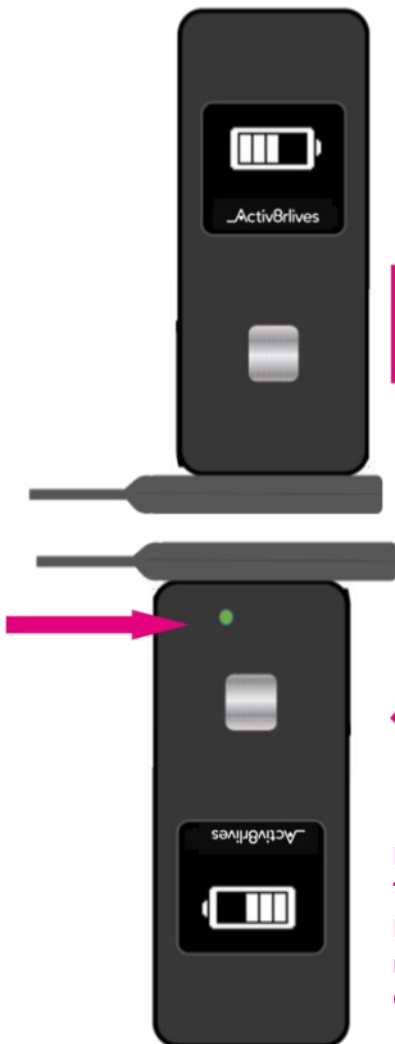

Rotate 180°  
Touch pins together  
Push against  
magnets  
Green light briefly shows



# PUFFClicker™

Smart pMD Inhaler Tracker



## Specifications

Type	Description
Dimension (L x W x H)	85mm x 45mm x 40mm
Weight of Module	25g (including battery)
Weight of PUFFClicker & Inhaler	35g
Inhaler Shaking	Conformational tick
Doses Counted	0-99,999 doses
Steps taken	0—99,999 steps
Memory	30-days on PUFFClicker
Stride distance input range	10—150cm
Age input range	5—90+ years
Communication Interface	Bluetooth Smart (4.0 or BLE)
Units	Metric or Imperial
Clock	24-hour clock
Splash proof	Splash proof and wipeable only
Operating/storage temperature	0—50°C
Eco-friendly	Auto turn-off without operation
Packaging	Fully recyclable
Rechargeable Battery	3.7V 100mAh rechargeable lithium ion battery. Expiration after 550 charges
Magnetic USB Charging Cable	DC 0.5—1 Amp charger. 120 minute charge time, lasts 10-14- days with typical use.
Layperson use	Intended for Layperson use.



### Module for PUFFClicker



Manufacturer: Aseptika Limited (Activ8rlives), Suite 5, SiTwo (formerly LDH House), Parsons Green, St Ives, Cambridgeshire, PE27 4AA, United Kingdom

Date of Manufacture 2022-02 **LOT** A1100

**Model** Activ8rlives PUFFClicker™ Accessory Module P089



Class I medical device **SN** Serial Number



Made in compliance with EU MDR 2017/745 as Class I medical device



Made in compliance with MDD 93/42/EEC as Class I Medical Device, amended by 2007/47/EC, which are given effect in UK law through MDR 2002 (SI 2002 No 618, as amended)



Integrated Lithium-ion battery, Input—DC—100mAh. **Expires** 500 cycles



0—50°C storage and operation Keep device dry



This product has not been sterilised



RoHS Directive (2011/65/EU)



The symbol in accordance with IEC EN 60601-1-2: 2007 in section 5.1.1 for products including RF transmitter



In accordance with IEC 60601-1 the product and its applied parts re type BF and thus protected against the risks of electrical leakage



EU Directive 2012/19/EU waste electrical and electronic equipment (WEEE) Do not dispose of in normal domestic waste at the end of its useful life



Read instructions before use. Intended use by Layperson <https://www.activ8rlives.com/mwdownloads/download/link/id/2>

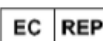

European Healthcare & Device Solutions Ltd (EHDSL), Stratton House, Bishopstown Road, Cork, T12 Y9TC, Ireland



506029317105920220206082023A1100

ASL TF-003 PUFFClicker PP 003 (V7.0)



## Warranty

**Activ8rlives** (Aseptika Limited) guarantees this product for one (1) year after the date of purchase. The guarantee does not cover the battery, packaging and damages of any kind due to misuse, such as: dropping or physical misuse caused by the user or water damage outside of the stipulated usage. Claimed products will be replaced when returned marked as **DAMAGED** together with the original proof-of-purchase. For any general enquiries or technical questions concerning the product or questions about the warranty, please contact **Activ8rlives** — details are on the back of this User Manual.



Aseptika Limited (Activ8rlives)  
Suite 5, SiTwo (formerly LDH House)  
Parsons Green  
St Ives  
Cambridgeshire  
PE27 4AA  
United Kingdom

t: +44 (0)1480 352 821  
e: [support@septika.com](mailto:support@septika.com)  
w: [www.activ8rlives.com](http://www.activ8rlives.com)

© Copyright Aseptika 2023. All rights reserved.

ASL TF-003 MAN/IFU10 PUFFClicker (V6.2)

Last updated 26.04.2023